

Mortuary Refrigerators / Freezers

Modern frost-free refrigeration and automatic temperature control.



www.evocare.com.au
Ph: 07 3355 8000 Fax: 07 3355 5043
Email: sales@evocare.com.au

Mortuary Refrigerators

These Refrigerators are **Australian designed and manufactured** to give the advantages of modern **frost-free** refrigeration and automatic temperature control.

Modular design allows gradual expansion of facilities as additional units can be aligned with cabinets already installed.

The cabinets can be reduced to the correct operating temperature within 20 minutes.

This also allows the number of units being kept under refrigeration to be used according to demand.

Stainless steel cabinet and stretchers ensure hygiene at clinical level.



New Improved Mortuary Refrigerators / Freezers

- Easy Glide out Stainless Steel Stretchers on Polypropylene Glide Rollers
- Large Control Panel with built in alarms – Audio & Visual with reactivation alarm & Mute Function for Alarm
- A digital display of the internal temperature is visible at all times
- Voltage free contacts which allow the alarm conditions to be continually monitored via a remote system within or external to a facility.
- Incorporates features that ensures the cadaver is not compromised when power fails
- Designed so that air and temperature loss is minimised when loading and unloading
- Interior Lighting
- Top Mounted Refrigeration System that requires no installation
- Waste Fitting for Hosing out
- Stainless Steel Interior and Exterior
- Alarm and recorder sensors are easily accessible and tolerate movement
- Uses a CFC Free Refrigerant
- Secured access to the Refrigerators/ Freezer
- Castors standard



Inside view showing polypropylene glide rollers

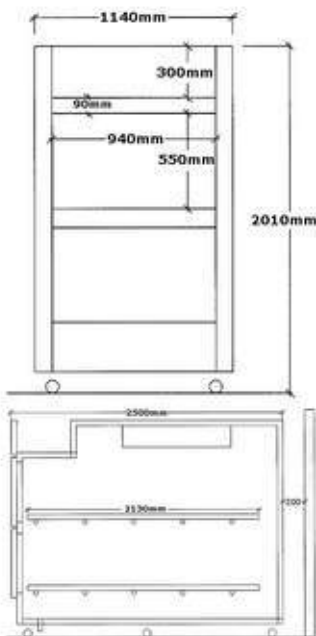

Dimension Bariatric 2 door Refrigerator, NBMR2 (mouseover to enlarge)



Optional:

- A built in temperature recorder
- An access port to accommodate external monitoring

MODEL NO.	BODY CAPACITY	WIDTH (mm)	DEPTH (mm)	HEIGHT OVERALL (mm)	HEIGHT TO LOAD POINTS (mm)	SWL (kg) per shelf
NBMR1	1	1140	2500	1370	430	300
NBMR2	2	1140	2500	2010	430/1070	300

NMRB-2



www.evocare.com.au
Ph: 07 3355 8000 Fax: 07 3355 5043
Email: sales@evocare.com.au

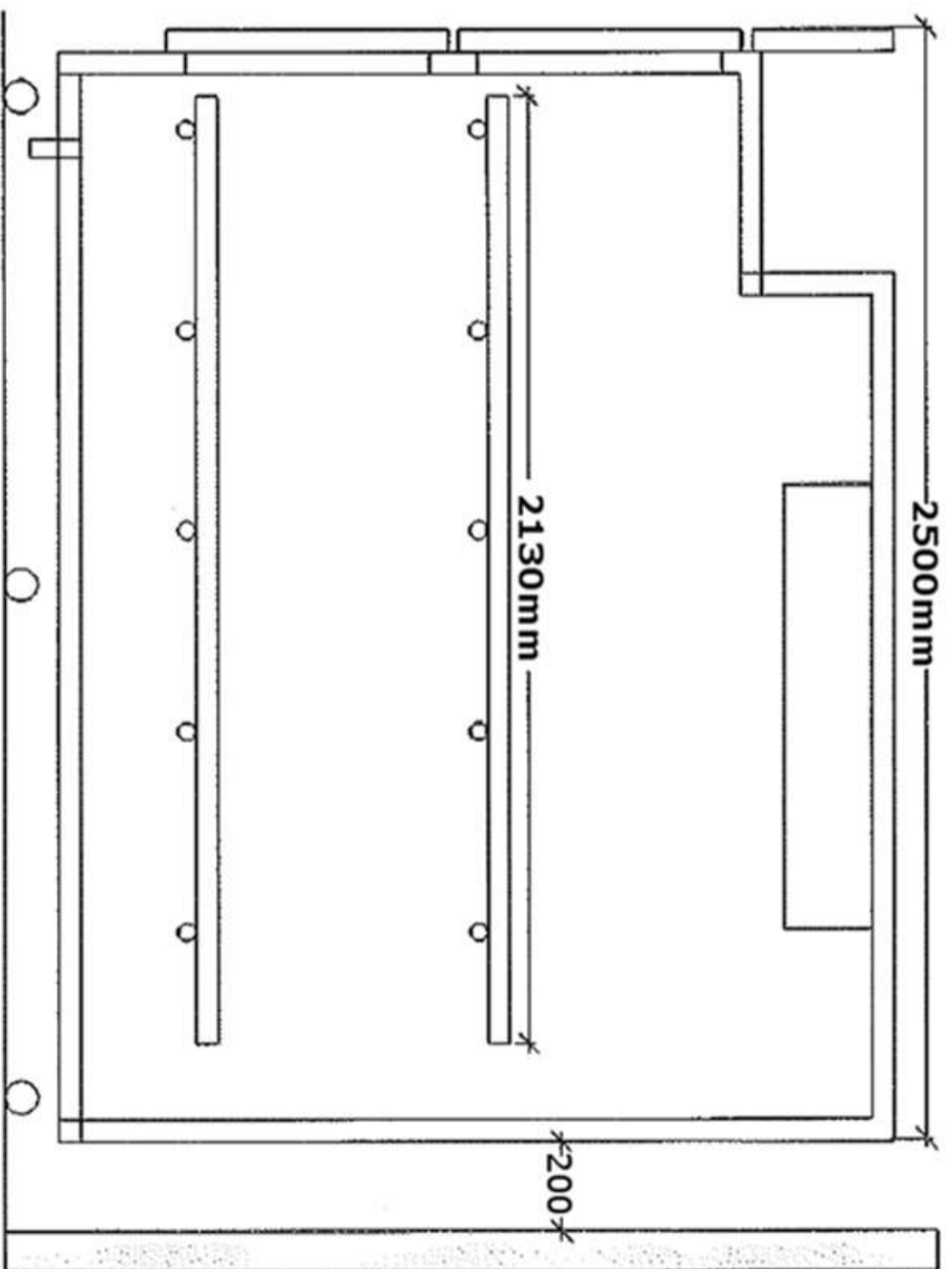
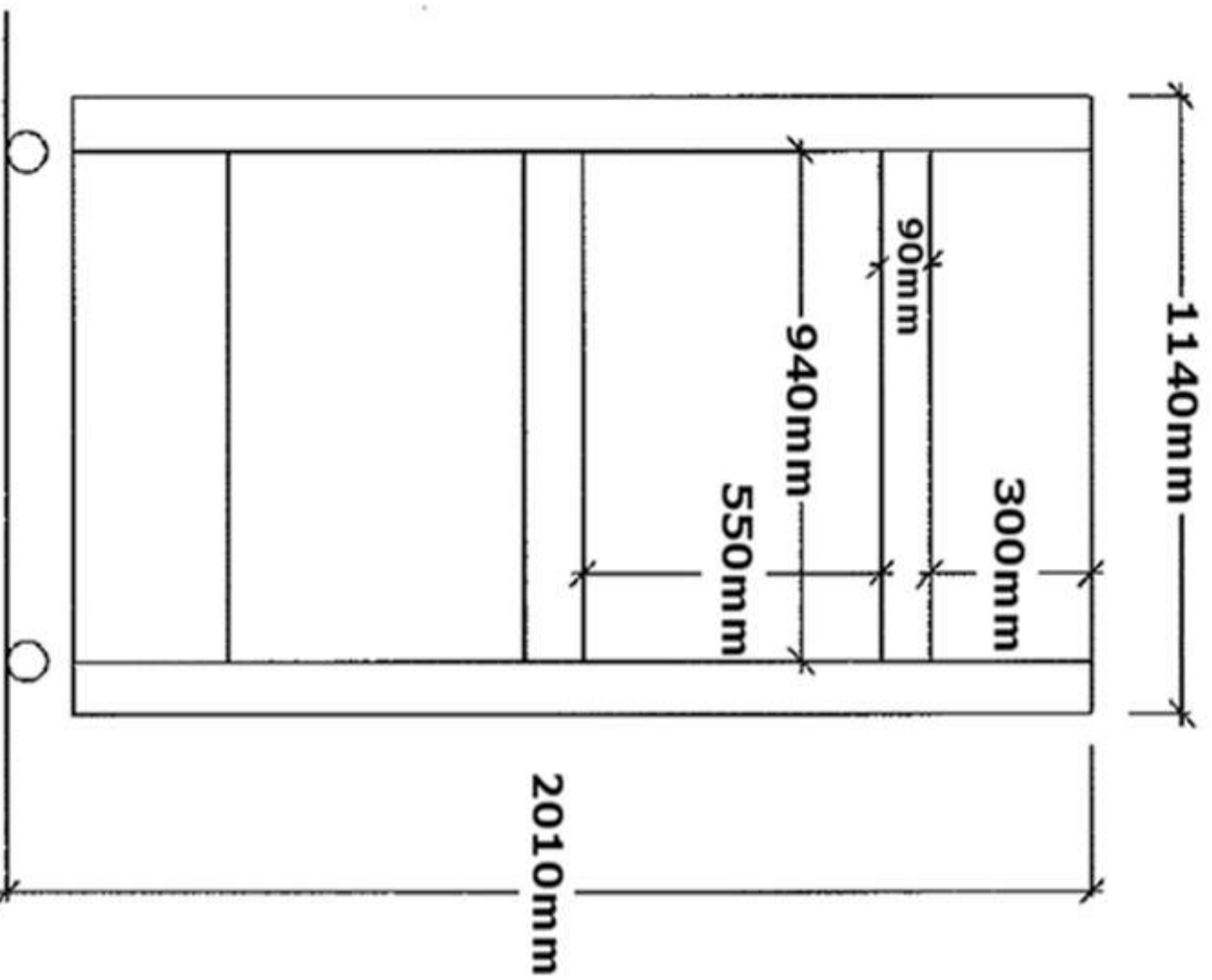

CONSTRUCTION

- Cabinets are built on the monostructure system which combines maximum useful internal space with minimum floorspace requirement.
- They are robust without being unduly heavy or bulky.
- The internal and external shells are stainless steel which combines clinical cleanliness and durability with a permanent attractive appearance.
- Polyurethane insulation is used to meet the particular requirements of refrigeration in mortuaries.

LEGS

- Castors as standard.

FITTINGS

- Fittings comprise heavy-duty chromium-plated handles and hinges
- Magnetic door gaskets
- Temperature indicator, on/off switch and running light.
- **Option:** Each door can be fitted with a holder for an identification card.

REFRIGERATION

- Top Mounted Refrigeration System that requires no installation.
- All cabinets are temperature controlled individually and can be isolated when not in use.
- Within the cabinet is a frost-free forced air circulation system and automatic temperature control.
- The refrigeration system is designed for a storage temperature of +2/+4°C in an ambient temperature of 43°C.
- Temperature Ranges: Refrigerators 2°C to 4°C, Freezers to -20°C;

DRAINS

- A 38mm drain is provided for connection to existing plumbing.
- An S/trap should be fitted between the cabinet drain outlet and existing plumbing.

STRETCHERS

- Stretchers are made of stainless steel
- The tubular frame holding the stretcher tray has integral hand slides at both ends.
- The stretchers are mounted on polypropylene glide rollers for easy handling.
- The tubular construction of the stretchers makes them light in proportion to their load-bearing capacity.

Tray dimensions for standard 610mm and bariatric 890mm

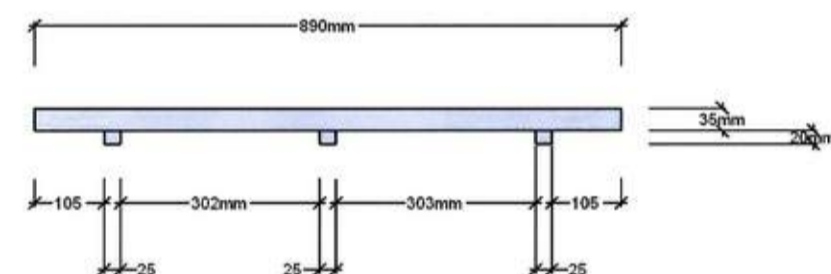
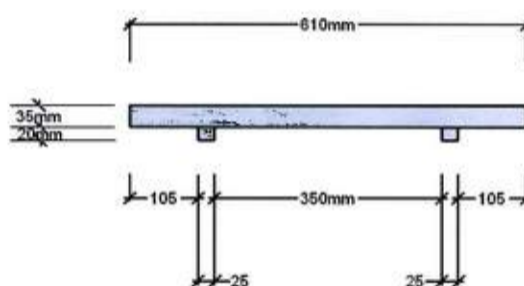
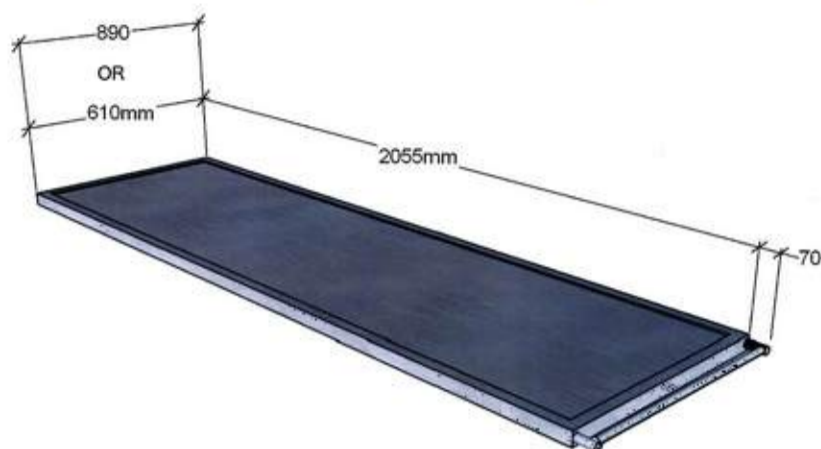

STACKER TROLLEYS

A stacker trolleys are available as an optional extra for easy stretcher loading.

INSTALLATION AND CLEANING

- The refrigerator should be installed in a level position in a well-ventilated position.
- All refrigerator units run on 240V 10amp single phase.
- The air inlet for the motor is at the front grill — the air outlet is on top of this unit at the front.
- Internal cleaning can be achieved by a hose or other means as the cabinet is provided with a drain point at the front.
- It is important to direct the hose away from the evaporator motors and all power.
- The power cord is on the left side of cabinet at the top approx 300mm from the front.
- As the above items are at the front/front top of the unit, the units are able to be positioned against walls or other units at the sides and rear — no clearances needed.
- In small areas an exhaust fan may be required.