

End covers for A/B/C rails have been changed; the end covers now overlap the rail, hence it is now sealed tightly to the rail – item numbers/prices remain unchanged

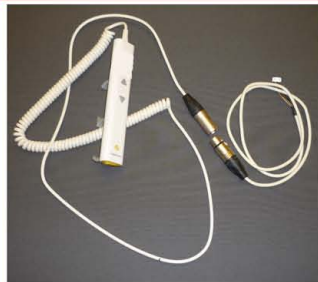

A GH1 hand control plus an extended cord (straight) in the length you need is now available

Item	Description
552619	Hand control for extension cable, GH1
552620	Extension for hand control 552619, GH1 (length to be indicated when ordered)

Remember to order both items!



A GH2/GH2F hand control including extended cord (straight) w. charging through hand control is now available

Item	Description
935064	Hand control including extended cord for GH2/GH2 F w. charging through hand control (length to be indicated when ordered)

Note! This modification can only be used in connection with GH2 without drive motor and only for DC version.

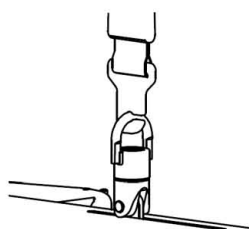

A new GH2/GH3 swivel link has been made in order to turn specific products 360 degrees without twisting the strap; hence avoiding activating the end stops up causing the hoist to stop

Item	Description
284520	Swivel link GH2/GH3, spare part

Compatible with:
 14600 Mobile Bath Chair incl. oval hook
 14610 Mobile Bath Stretcher incl. oval hook
 28445 Horizontal lifter, foldable, 250 kg
 28456 Horizontal lifting support w. weight adjustment, 350 kg

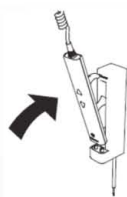

Two new variations of GH3 hoists with charging through hand control have been made

Item	Description
554045	GH3 250 110 000 w. charging through hand control
554046	GH3 200 110 000 w. charging through hand control

These hoists can be a candidate when needing to run GH3 in mini/maxi/jumbo rails or if charging liners are not optimal when fitted in a humid/wet environment. In addition the hoist 554045 has more capacity than the GH1 models.

Separate item numbers for **coated switch tracks** are now available:

Item	Description
554027	Switch track right 90° GH with coating
554028	Switch track left 90° GH with coating