

Mobile Baby Bassinet



User Guide



ARTG Number: 173090

Evocare Australia Pty Limited

PO Box 1144, Stafford Q 4053 Australia

Phone: 07 3355 8000

Fax: 07 3355 5043

E-mail: sales@evocare.com.au

Website: www.evocare.com.au

REV.1.2 20 JULY, 2010

To request product service and order replacement parts, please call:

Customer Service: 07 3355 8000

Spare Parts: 07 3355 8007

8.30 am to 5.00 pm Monday to Friday

Email: sales@[evocare.com.au](mailto:sales@evocare.com.au)

If the product does not function properly contact [Evocare](#) Australia.

When requesting service, please provide the following information:

1. Part Code and Description
2. Date of Purchase

Address: Evocare Australia Pty Limited
260 South Pine Road, Enoggera, Qld. 4051
P.O. Box 1144, Stafford, Qld. 4053

Specifications

Product Description

The Evocare Mobile Baby Bassinet is a sturdy unit ideal for use in the Hospital Maternity Wards, home use or for hire. The unit is available in attractive green, blue or pink trim with matching castors.

Dimensions

With Bassinet Fitted

Overall length: 870mm
Overall width: 530mm
Height: 920 to 1070mm (Gas Spring adjustment)
SWL: 20 kgs

Bassinet Only

Overall length: 820 mm
Max height: 265 mm
Overall width: 480 mm
SWL: 10 kgs

Features

Trendelenburg and reverse Trendelenburg:

0 - 12 degrees (Gas Spring adjustment)

Castors: Colour matched to trim of bassinet.

100mm polyurethane single wheel

two swivel, two braking (on opposite corner)

Steel base

Clear ABS Bassinet for visibility.

Two recessed storage compartments in base.

Plastic bumper handles at each corner.

Mattresses:

EVBBMT-60H—60mm deep, Hospital Grade Foam—HG 39 - 170 (Hospital Grade (HG) foams are high-density conventional type foams that are flame retarded. These foams are specifically developed for the use in health care mattresses, Hospital Grade foams are manufactured with Ultra-Fresh® anti-microbial protection for a healthier environment.), **with Carrflex Cover** (Vapour permeable, water resistant, fire retarded, anti-microbial).

EVBBMT-50—50mm deep, ST30-130 grade foam, fully sewn Carrflex Heavy BI 115 FRC covering.



Operating Instructions

Braking Castors

When leaving the bassinet unattended, lock the braking castors. To lock the castors, press the **red** brake pedal on the front of the braking castor so that it locks down.

Release the braking castors before moving. To release the brake, step on the back of the **red** brake pedal on the braking castor.

Height Adjustment

To adjust the height, use lever control (13). Squeeze the **red** lever to the stop, the gas spring will assist raising the bassinet. To lower, squeeze the **red** lever to the stop and push down on the stop. DO NOT lift by the bassinet capsule only. The height range is 920mm to 1070mm.

Trendelenburg Adjustment

The Trendelenburg Adjustment Lever is located on the left-hand side of the Bassinet Frame (12). Squeeze the **red** lever to the stop and push up or down to adjust the amount of tilt.

Check institution practice guidelines re: adjustments of bassinet with baby in-situ.

Parts

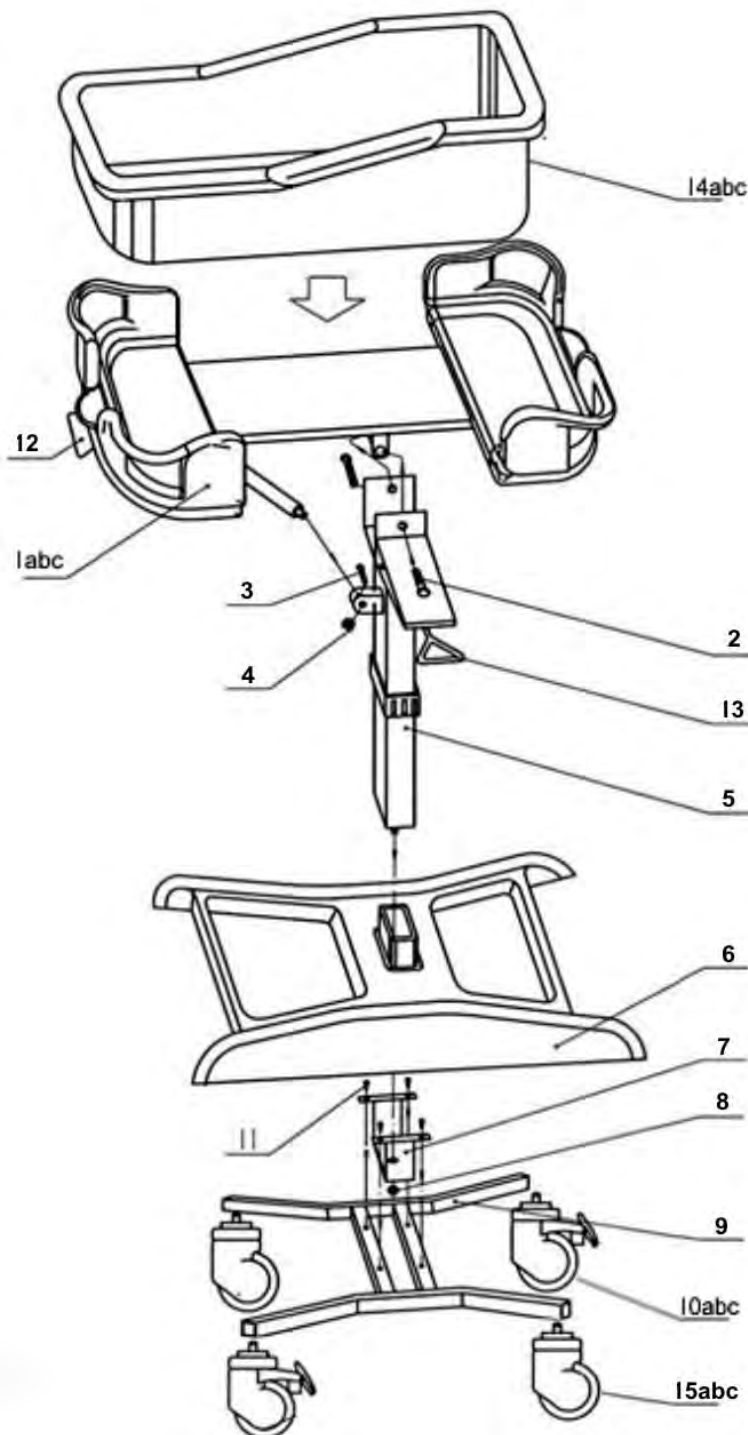

Parts List:

- 1a. Mobile Bassinet frame—Green Trim
- 1b. Mobile Bassinet frame—Blue Trim
- 1c. Mobile Bassinet frame—Pink Trim
- 2. Bolt
- 3. Bolt
- 4. Nut
- 5. Support stem
- 6. Frame protector including two recessed storage compartments
- 7. Frame/Protector connection
- 8. Locking nut
- 9. Mobile base
- 10a. Locking Castor—Green Trim (Part No. 246GLC)
- 10b. Locking Castor—Blue Trim (Part No. 246BLC)
- 10c. Locking Castor—Pink Trim (Part No. 246PLC)
- 11. Tightening bolt
- 12. Trendelenburg control
- 13. Height adjustment control
- 14a. Bassinet Capsule only—Green Trim (Part No. EVBBG)
- 14b. Bassinet Capsule only—Blue Trim (Part No. EVBBB)
- 14c. Bassinet Capsule only—Pink Trim (Part No. EVBBP)
- 15a. Swivel Castor—Green Trim
- 15b. Swivel Castor—Blue Trim
- 15c. Swivel Castor—Pink Trim
- 16. Mattress 60 mm - Hospital grade foam HG39-170. Fully welded cover. (Part No. EVBBMT-60H)
- 17. Mattress 50mm - ST30-130 grade foam, fully sewn Carflex Heavy BI 115 FRC covering, mainly for home or hire use. (Part No. EVBBMT-50)

Warranty:

1. Evocare provides consumers with the following warranty in relation to this Product, in addition to complying with the requirements of any relevant legislation, including the *Competition and Consumer Act 2010* (Cth) in Australia and the *Consumer Guarantees Act 1993* in New Zealand (the Acts), except where a New Zealand consumer acquires the Product for the purposes of a business.
2. In this warranty, we have used the following definitions:
 - (a) **Form** means a warranty claim form issued by Evocare in respect of Products;
 - (b) **Evocare** or **our** means Evocare Australia Pty Limited, ABN 98 078 566 604 of Level 19, 144 Edward Street, Brisbane 4000;
 - (c) **Products** means the goods manufactured for Evocare (including products manufactured by its contract manufacturers);
 - (d) **Material** means a material or component used by Evocare in the manufacture of the Products;
 - (e) **Retailer** means the authorised dealer of Products from whom the Product was purchased;
 - (f) **Warranty Period** means the warranty period commencing from the date of purchase of the relevant Product. If the Product or part (as the case may be) is repaired or replaced, there will be no extension to the original warranty period; and
 - (g) **Workmanship** means the handling, assembly and manufacturing processes performed by or on behalf of Evocare in order to manufacture the Products.
3. Evocare warrants that for the duration of the Warranty Period, all Products will be free of faults arising from defects in Workmanship or Materials, on the terms and conditions set out in this warranty.
4. Evocare undertakes that if during the Warranty Period any Product, or any part of a Product, has failed to operate correctly due to faulty Workmanship or defective Material, it will repair or replace the Product or part (as the case may be) free of charge provided that the following procedures are met :
 - (a) The consumer must contact the Retailer or Evocare upon becoming aware of any defect to a Product upon which the consumer will be required to complete a Form and provide satisfactory proof of purchase.
 - (b) Evocare will review the Form to determine whether there is a defect, and if so Evocare agrees to (at its option) repair, replace or supply equivalent goods, or pay the cost of any of those remedies to the consumer.
 - (c) If Evocare requests the return of the applicable Product or part, the consumer will be responsible for the collection and freight costs of returning that Product or part to Evocare.
 - (d) The consumer acknowledges that it is also responsible for the freight costs to deliver any new Product or replacement part to it.
5. This warranty is in addition to any non-excludable legal rights or remedies conferred on the consumer under any applicable Act and any similar laws. To the extent permitted by law, Evocare's liability for any non-excludable condition or warranty is limited to rectifying any defect at its option, as set out in paragraph 4(b).
6. Subject to the requirements of any applicable Act or legislation and to the extent permitted by law, no liability (whether expressed or implied) of any nature whatsoever, is accepted by Evocare for any consequential loss, damage or injury arising as a result of any fault in the Products.
7. This warranty does not extend to damage to Products which occurs during transit or transportation, or which is caused by any abuse, accident or improper installation, connection, use, adjustment or repair or use of goods otherwise than in accordance with instructions issued by Evocare.
8. The warranty on Products is waived if any addition or attachment to the Products do not have Evocare's approval or are not sold as Evocare products. The Products are designed to perform specific tasks under established test loads and unauthorised attachments may produce stresses for which the design is not appropriate.
9. The following applies to consumers who purchased a relevant Product in Australia:

Our goods come with guarantees that cannot be excluded under the Australian Consumer Law. You are entitled to a replacement or refund for a major failure and compensation for any other reasonably foreseeable loss or damage. You are also entitled to have the goods repaired or replaced if the goods fail to be of acceptable quality and the failure does not amount to a major failure.

Warranty (cont.) & Maintenance:

Warranty

The Bassinet has a one Year Warranty against defects or bad workmanship. The warranty does not cover misuse or neglect.

Maintenance

To ensure long life and safety the Mobile Baby Bassinet should be serviced every twelve (12) months. (Six (6) months in a hire situation). Maintenance must be carried out by Evocare Australia or a service agent approved by Evocare Australia to maintain warranty.

Cleaning

Disinfecting bassinet and mattress should be carried out after use, particularly in Hospital Ward situations. Cleaning and Disinfecting can be carried out with the following products:

- Neutral Detergent pH 6 -8in either a aqueous solution of impregnated wipe.
- Sodium Hypochlorite – presented as 1000 parts per million of available chlorine, usually achieved by a 1 in 50 dilution of 5% liquid bleach.
- Alcohol Disinfectants – presented as 70% isopropyl alcohol.
- Chlorine—releasing disinfectants.
- Hospital Grade Disinfectants – Hydrogen Peroxide, Benzalkonium Chloride, Coco alkyl dimethylbenzyl ammonium chloride,
- Phenolic Disinfectant not recommended
- Ultraviolet
- Ozone suffocation
- DO NOT use abrasive cleaning products

Troubleshooting:

Description of the problem	Analysis of the problem	Recommended solution
Brake failure	Incorrect operator application	Refer to Operators Manual
Brake failure	Check castor for damage	Replace damaged castor
Height adjustment or Tilt adjustment does not work	Check that the nut or the spring is loose	Readjust and tighten the nut
Height adjustment or Tilt adjustment does not work	The nut is too tight	Readjust the nut
Height adjustment or Tilt adjustment does not work	The spring is damaged	Change the spring
Trendelenburg adjustment does not work	Check Trendelenburg activator button control	Make sure the activator button is clean

Labels

Location of Labels



Labels for Baby Bassinet with Green trim (Size 60mm x 40mm)



Label for Infant Bed with Green trim (Size 75mm x 50mm)



Labels for Baby Bassinet with Blue trim (Size 60mm x 40mm)



Label for Infant Bed with Blue trim (Size 75mm x 50mm)



EVOCARE AUSTRALIA PTY LIMITED

PO Box 1144
Stafford Q 4053
Australia

Phone: 07 3355 8000
Fax: 07 3355 5043
E-mail: sales@evocare.com.au

Website: www.evocare.com.au